

This drawing, written description or specification represents a proprietary product of TELEX, Lincoln, NE., and shall not be released, disclosed nor duplicated without the written permission of TELEX.

REVISIONS				
CHANGE #	REV	DESCRIPTION OF CHANGE	DATE	CHK BY
41-000255	A	RELEASE TO PRODUCTION	7.22.2005	PBH
41-000313	B	ADD 803629, 804230-1, 804142-6, DELETE 2 PCS OF 51709000	11/11/05	PBH
7-33088	03	F01U178030 WAS 8800148959, CHANGED NOTE 3	10/19/11	KH

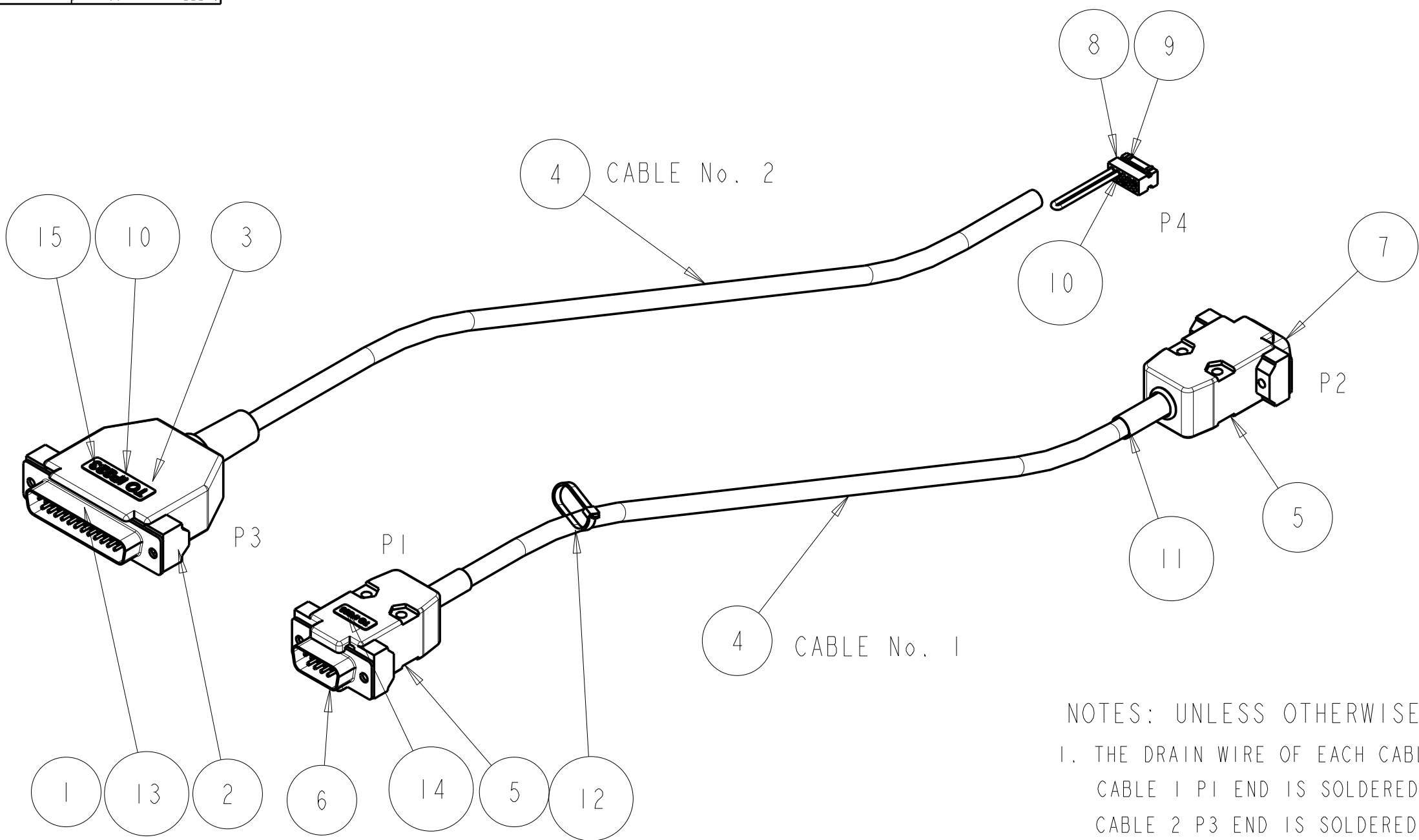

NOTES: UNLESS OTHERWISE SPECIFIED

1. THE DRAIN WIRE OF EACH CABLE MUST BE CONNECTED AS FOLLOWS:
CABLE 1 P1 END IS SOLDERED TO THE CONNECTOR SHELL. THE P2 END IS SOLDERED TO THE CONNECTOR SHELL
CABLE 2 P3 END IS SOLDERED TO THE CONNECTOR SHELL. CLIP DRAIN WIRE AT P4 END. DO NOT CONNECT.
2. PLACE HEATSHRINK TUBING (P/N F01U178030) OVER ALL DRAIN WIRES BEFORE SOLDERING TO CONNECTOR SHELL.
3. PLACE TIE WRAP (ITEM 12) OVER BOTH CABLES AT AREA INDICATED. APPROXIMATELY 3" FROM CONNECTORS.

WIRING TABLE

PIN	TO	PIN	COLOR	CABLE No.
P1-2	-	P2-11	WHITE	1
P1-3	-	P2-10	BROWN	1
P1-5	-	P2-15	BLACK	1
P3-2	-	P3-7	BLACK	ITEM 10
P3-7	-	P4-2	BLACK	2
P3-14	-	P4-6	GREEN	2
P3-24	-	P4-9	WHITE	2
P3-25	-	P4-7	BROWN	2
P4-1	-	P4-3	BLACK	ITEM 10

1	LABEL LARGE "TO IP-223"	15	804142-6	
1	LABEL, SMALL "TO IP223"	14	804230-1	
1	LABEL, TELEX	13	803629	
1	TIE WRAP	12	51709000	
0.250	HEAT SHRINK TUBING	11	F01U178030	
0.299	WIRE FLEX LEAD	10	01450-311	UNIT OF MEASURE IS FT
6	CONTACTS, SPLIT PIN, HIROSE, DF11-2428SC	9	539243000	
1	HIROSE, DF11-10DS-2C, CONNECTOR	8	591731000	
1	CONNECTOR, 15 PIN MALE, D-SUB	7	640179	
1	CONNECTOR, 9 PIN MALE D-SUB	6	8800102114	
2	HOUSING, 9 PIN D-SUB CONNECTOR	5	6503681	
4.000	CABLE, 7 CONDUCTOR 24AWG, SHIELDED	4	550252	PART OF 880167
1	STRAIN RELIEF	3	63351004	
1	HOUSING, 25 PIN D-SUB CONNECTOR	2	650369	
1	CONNECTOR, 25 PN D-SUB	1	8800101954	
QTY	DESCRIPTION	ITEM	PART NUMBER	ADDITIONAL INFORMATION

UNSPECIFIED LIMITS OF TOLERANCE
DECIMAL: FRACTION:
.X = ±.050 IN MACHINED
.XX = ±.030 IN FINISH
.XXX = ±.010 IN
ANGLES ± 1°, BENDS ±2°
STRAIGHTNESS AND/OR
FLATNESS .005 IN./1 IN.
CONCENTRICITY
UNMARKED ANGLES, BENDS
AND INTERSECTIONS 90°
THREADS - EXT. CLASS 2A
INT. CLASS 2B

DR BY	JJS
CHK BY	SKL
APPR'D	PBH
PROD	KR

Telex®
TELEX COMMUNICATIONS INC.
Lincoln Nebraska U.S.A.

TITLE
CABLE ASSEMBLY, IP-223/SEPURA SRM2000 INTERFACE

MAT'L SEE BOM TABLE	SIZE C	CODE IDENT 57010	DWG. No. F01U190208
	SCALE: NONE		SHEET: 1 OF 1